

LANDSCAPE ARCHITECTURE

Coastal Resources, Inc. (CRI) has experience in providing landscape architecture services for a variety of clients. CRI's licensed landscape architects, DNR Forest Conservation Qualified Professional, and arborists are accomplished at evaluating the aesthetic of a site, determining the appropriate planting species/density, and preparing landscape design documents to provide our clients with a successful project. Types of services CRI provides include:

- Landscape Design/Reforestation
- Stream Restoration Projects
- Stormwater Management Planting
- Environmental Site Design
- Wetland Creation/Enhancement
- TMDL Tree Planting
- Urban Streetscapes
- Critical Area Planting

CRI staff hold current certifications that are essential to provide appropriate landscape plans including Licensed Landscape Architects, DNR Forest Conservation Qualified Professionals, and ISA Certified Arborists.

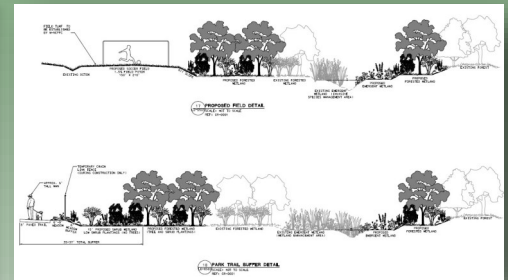

Our landscape architecture staff have experience providing the following services:

- Streetscapes
- Vegetation inventories
- Concept Development
- Design Plan Development including Plans, Specifications and Estimates
- Pollutant Removal Calculations
- Schematic Cross Sections and Typical Sections
- Forest Mitigation Plan Development
- Vegetation Management Plans
- Coordination with Local Communities and Jurisdictions

For more information about our Landscape Architecture services please contact us at 410-956-9000 or visit www.coastal-resources.net.

CRI is a small, woman-owned certified Minority Business Enterprise/Disadvantaged Enterprise (MBE/DBE/WBE/SBE/WOSB) with over 40 years of experience in natural resource assessments, permitting, mitigation, restoration design, and monitoring.

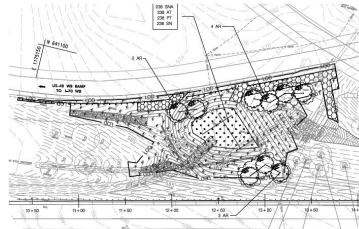

Coastal Resources, Inc. 25 Old Solomons Island Road, Annapolis, MD 21401